

NOTES:

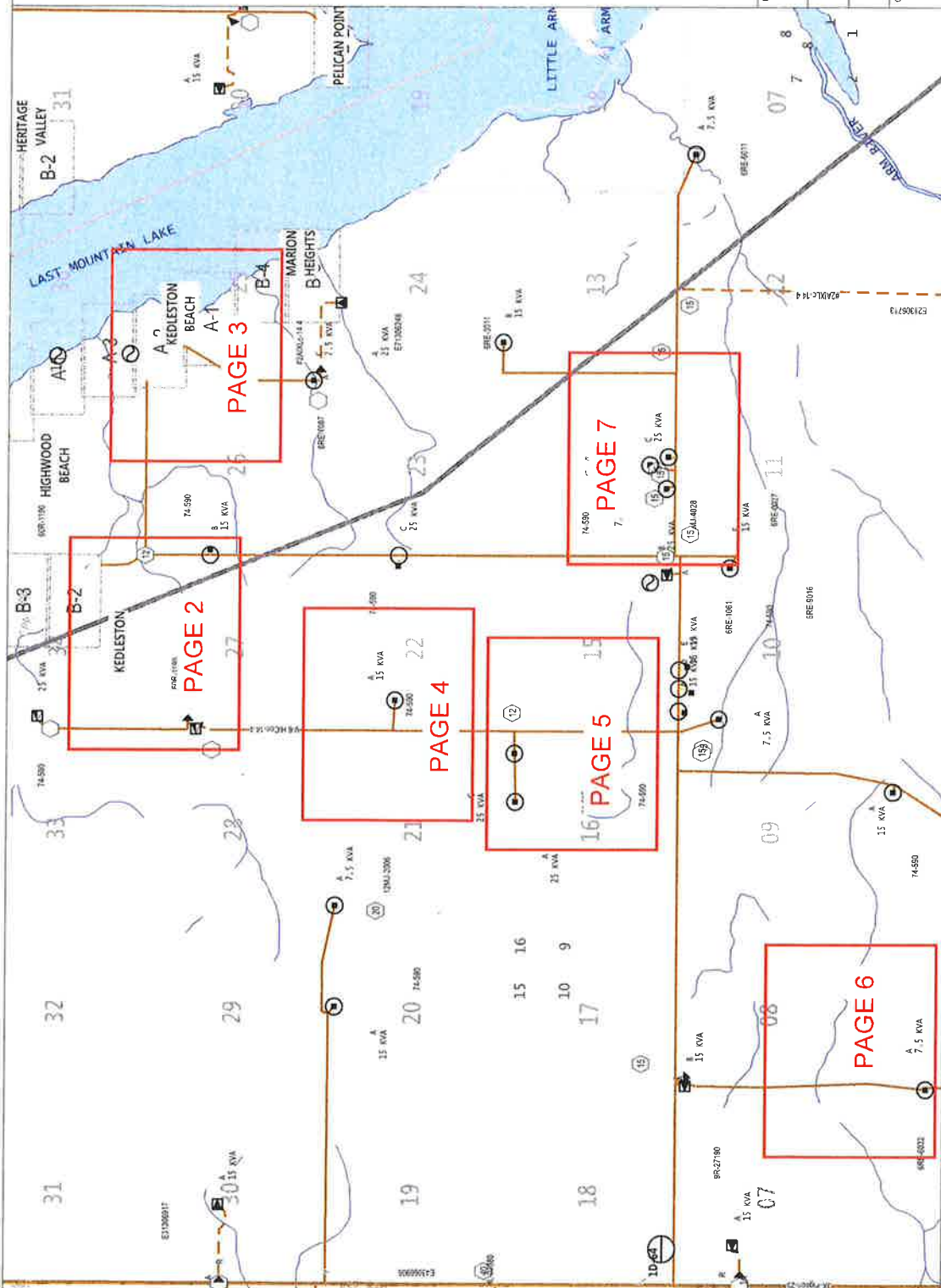

DRAWING TITLE		WPMP 2021 RPL-Lumsden 1D64
NOTIFICATION NUMBER	SERVICE ORDER NUMBER	20278269
LEGAL LAND DESCRIPTION OR CIVIC ADDRESS	LONGLAT OF AREA	NW 22-21-23 W2 -105, 12340, 50 802856
CUSTOMER CONTACT		SASKPOWER
EO PROJECT NUMBER	RE11LU0100011869	
FEEDEE NAME	LUM-562	CIRCUIT NAME 1D-64
DESIGNER NAME	JARSENBAUT	DISTRICT LUMSDEN
SITE CHECKED BY AND DATE		
RM NAME AND NUMBER	DUFFERIN 190	
PLOT DATE	2020-05-25	PLOT TYPE B P01
SHEET NO	1	REV

I HEREBY AGREE TO THE ROUTE OF THE POWER LINE AS SHOWN ON THIS PLAN, SUBJECT TO ALL LAND RIGHTS AND REGULATORY APPROVALS.

CUSTOMER
DATE

Rev No.	Rev By	Date	Description

APPROVED FOR CONSTRUCTION
MAY 26TH 2020

THIS MAP IS A VISUAL REPRESENTATION ONLY AND NOT TO BE USED FOR LOCATING FACILITIES.
CONTACT SASK 1ST CALL AT 1-866-828-4888 FOR LOCATES

NOTES:

-ALL STRUCTURES CAN BE FOUND IN THE SASKPOWER CONSTRUCTION STANDARDS MANUAL(CSM)
 -CALL FOR LOCATES PRIOR TO CONSTRUCTION
 -UNLESS SPECIFIED, ALL AREAS TO BE BACKFILLED WITH NATIVE MATERIAL

1. SALVAGE EXISTING POLE TAGS #2106427, 2106426 AND 2106420. INSTALL NEW 5/35' POLE AND A1201 TANGENTS.
2. SALVAGE EXISTING POLE TAG #2106419. INSTALL NEW 5/40' POLE AND A1201 TANGENT.
3. SALVAGE EXISTING POLE TAG #2109195. INSTALL NEW 5/40' POLE, A1205 DEADEND, A0808 TRANSFORMER STRUCTURE, GROUND GRID TYPE "C", A3203 GUY, A3215 ANCHOR, A2411 FARM POWER CENTER AND SOCKET TYPE METER.

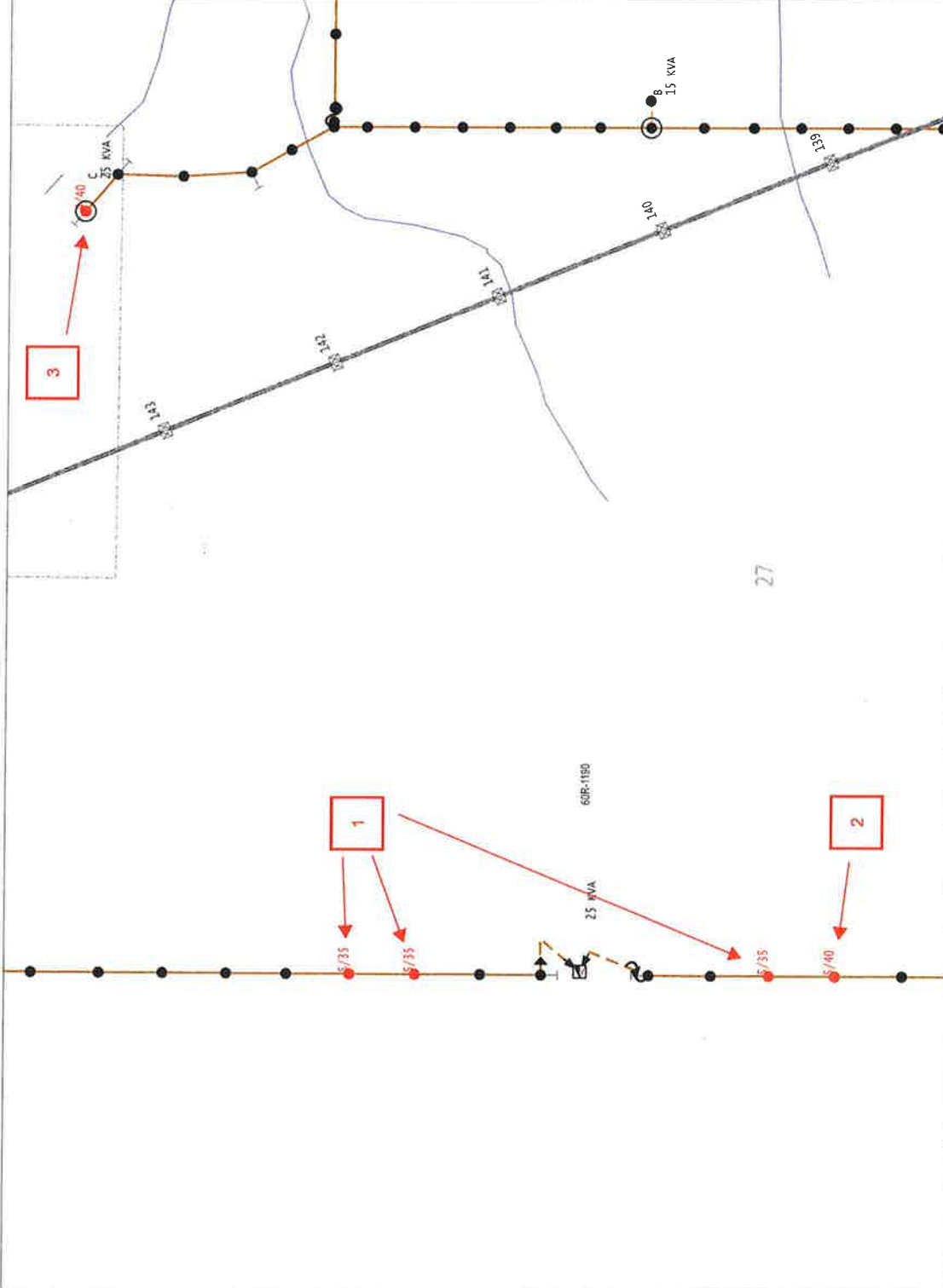

DRAWING TITLE		WPMP 2021 RPL-Lumsden 1D64	
NOTIFICATION NUMBER	11596691	SERVICE ORDER NUMBER	20278269
LEGAL LAND DESCRIPTION OR CIVIC ADDRESS	NW 22-21-23 W2	LONGITUDE OF AREA	-105,12340, 50,802855
CUSTOMER CONTACT		SASKPOWER	

EO PROJECT NUMBER	RE11LU0100011869
FEDDER NAME	LUM-562
DESIGNER NAME	JATESHAULT
CIRCUIT NAME	1D-64
DISTRICT	LUMSDEN
SITE CHECKED BY AND DATE	
RM NAME AND NUMBER	DUFFERIN 190
PLOT DATE	2024-06-25
PLOT TYPE	B P64
SHEET NO	2 OF 3
REV	

I HEREBY AGREE TO THE ROUTE OF THE PROPOSED POWER LINE AS SHOWN ON THIS PLAN (SUBJECT TO OBTAINING ALL LAND RIGHTS AND REGULATORY APPROVALS).

CUSTOMER
 DATE _____

Rev No.	Rev By	Date	Description

SaskPower

APPROVED FOR CONSTRUCTION
 MAY 26TH 2020

THIS MAP IS A VISUAL REPRESENTATION ONLY AND NOT TO BE USED FOR LOCATING FACILITIES. CONTACT SASK 1ST CALL AT 1-866-828-4888 FOR LOCATES.

NOTES:

- ALL STRUCTURES CAN BE FOUND IN THE SASKPOWER CONSTRUCTION STANDARDS MANUAL(CSM)
- CALL FOR LOCATES PRIOR TO CONSTRUCTION
- UNLESS SPECIFIED, ALL AREAS TO BE BACKFILLED WITH NATIVE MATERIAL
- 4. SALVAGE EXISTING POLE TAGS #2109214, 2109215 AND 2109296. INSTALL NEW 5/40' POLE AND A1201 TANGENTS.
- 5. SALVAGE EXISTING POLE TAG #2109218. INSTALL NEW 4/45' POLE AND A1201 TANGENT.
- 6. SALVAGE EXISTING POLE TAG #2109280. INSTALL NEW 5/35' POLE AND A1411 DEADEND.
- TRANSFER (3) SECONDARY SERVICES AND SASKTEL JOINT USE.
- 7. SALVAGE EXISTING POLE TAG #2109241. INSTALL NEW 4/40' POLE, A1201 TANGENT A1408 TANGENT AND A1411 DEADEND.
- TRANSFER SASKTEL JOINT USE.

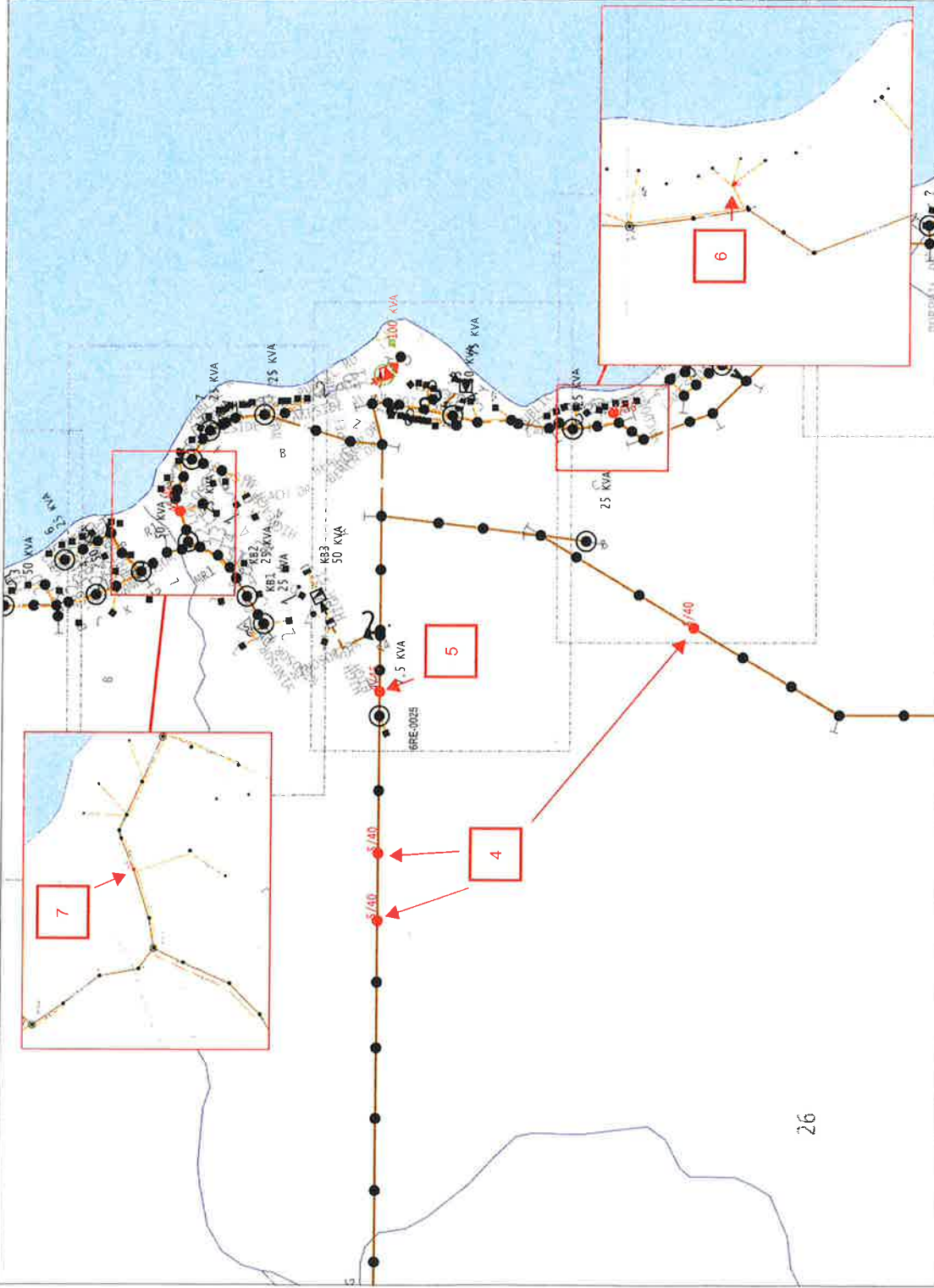

DRAWING TITLE		WPMP 2021 RPL-Lumsden 1D64	
NOTIFICATION NUMBER	SERVICE ORDER NUMBER		
11596691	20278269		
LEGAL LAND DESCRIPTION OR CIVIC ADDRESS		LONG/LAT OF AREA	
SW 36-21-23 W2		-105.07384, 50.822605	
CUSTOMER CONTACT			
SASKPOWER			
EO PROJECT NUMBER	RE11LU0100011869		
FEEDER NAME	LUM-562		
DESIGNER NAME	JRS/BRB/BL		
CIRCUIT NAME	1D-64		
DISTRICT	LUMSDEN		
SITE CHECKED BY AND DATE			
RM NAME AND NUMBER	DUFFERIN 190		
PLOT DATE	2020-05-25	PLOT TYPE	B POI
SHEETING	3	#	1
REV			

I HEREBY AGREE TO THE ROUTE OF THE PROPOSED POWER LINE AS SHOWN ON THIS PLAN (SUBJECT TO OBTAINING ALL LAND RIGHTS AND REGULATORY APPROVALS)

CUSTOMER _____

DATE _____

APPROVED FOR CONSTRUCTION
MAY 26TH 2020

SaskPower

THIS MAP IS A VISUAL REPRESENTATION ONLY AND NOT TO BE USED FOR LOCATING FACILITIES. CONTACT SASK 1ST CALL AT 1-866-628-4888 FOR LOCATES.

Rev No.	Rev By	Date	Description

NOTES:

- ALL STRUCTURES CAN BE FOUND IN THE SASKPOWER CONSTRUCTION STANDARDS MANUAL(CSM)
- CALL FOR LOCATES PRIOR TO CONSTRUCTION
- UNLESS SPECIFIED, ALL AREAS TO BE BACKFILLED WITH NATIVE MATERIAL
- 8. SALVAGE EXISTING POLE TAGS #2106413, 2106412 AND 2106411. INSTALL NEW 5/40' POLE AND A1201 TANGENTS.
- 9. SALVAGE EXISTING POLE TAGS #2106391 AND 2106389. INSTALL NEW 5/35' POLE AND A1201 TANGENT.

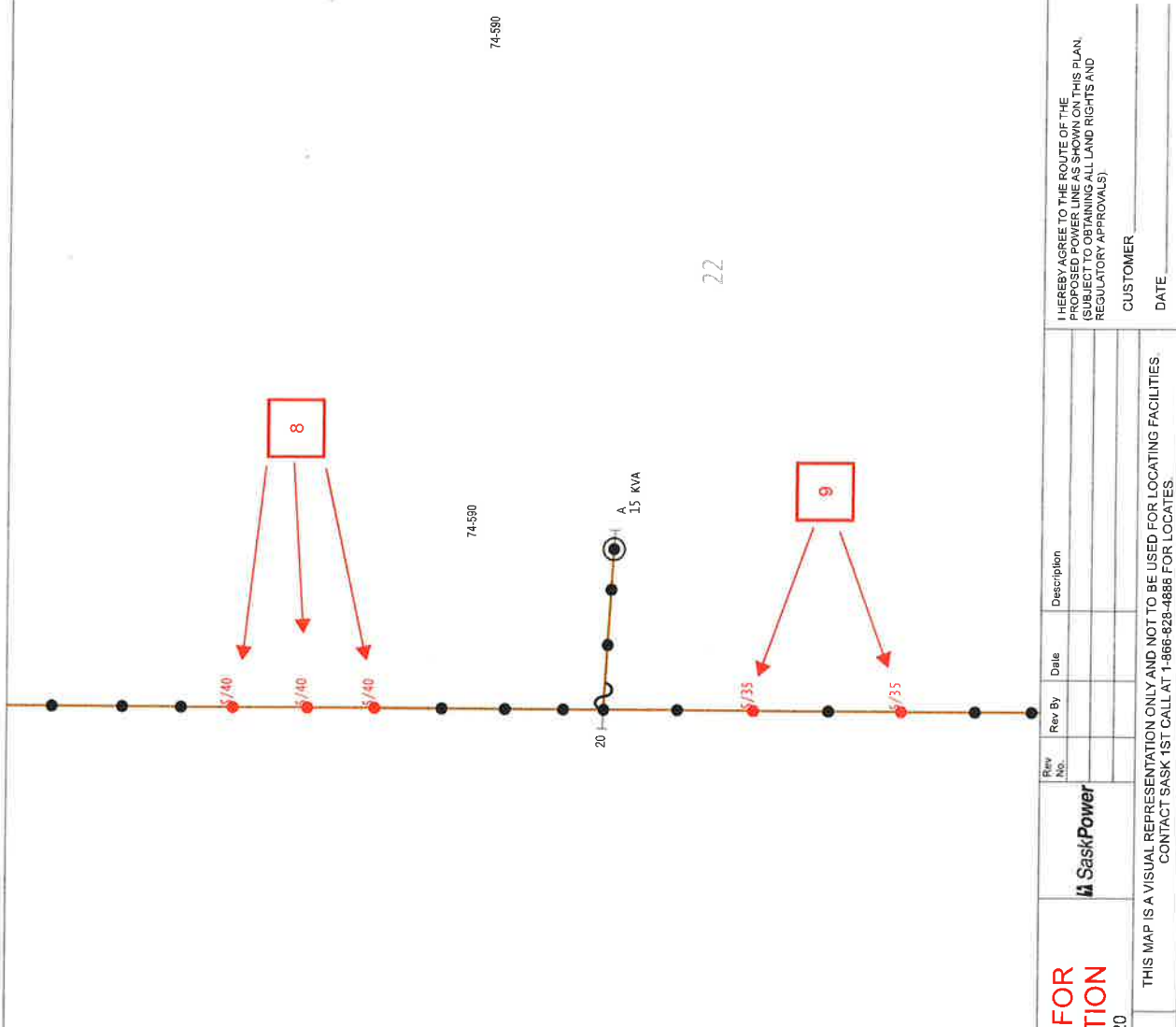

DRAWING TITLE	
WPMP 2021 RPL-Lumsden 1D64	
NOTIFICATION NUMBER	SERVICE ORDER NUMBER
11596691	20278269
LEGAL LAND DESCRIPTION OR CIVIC ADDRESS	LONG/LAT OF AREA
NW 22-21-23 W2	-105.12340, 50.802856
CUSTOMER CONTACT	
SASKPOWER	

ED PROJECT NUMBER	RE11LU010001869
FEEDER NAME	LUM-562
DESIGNER NAME	JR/SENIBUIT
DISTRICT	LUMSDEN
CIRCUIT NAME	1D-64
SITE CHECKED BY AND DATE	
PM NAME AND NUMBER	DUFFERIN 130
PLAT DATE	2024-05-25
PLAT TYPE	B Pdf
SHEET NO	4 of 7
REV	

I HEREBY AGREE TO THE ROUTE OF THE PROPOSED FACILITIES AS SHOWN ON THIS PLAN, (SUBJECT TO OBTAINING ALL LAND RIGHTS AND REGULATORY APPROVALS)

CUSTOMER _____

DATE _____

Rev No.	Rev By	Date	Description

APPROVED FOR CONSTRUCTION

MAY 26TH 2020

THIS MAP IS A VISUAL REPRESENTATION ONLY AND NOT TO BE USED FOR LOCATING FACILITIES. CONTACT SASK 1ST CALL AT 1-866-828-4888 FOR LOCATES

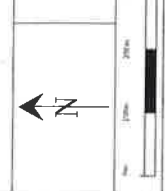

21

22

NOTES:

- ALL STRUCTURES CAN BE FOUND IN THE SASKPOWER CONSTRUCTION STANDARDS MANUAL(CSM)
- CALL FOR LOCATES PRIOR TO CONSTRUCTION
- UNLESS SPECIFIED, ALL AREAS TO BE BACKFILLED WITH NATIVE MATERIAL
- 10. SALVAGE EXISTING POLE TAG #2106383. INSTALL NEW 5/35' POLE AND A1201 TANGENT.
- 11. SALVAGE EXISTING POLE TAG #2106375. INSTALL NEW 5/40' POLE AND A1201 TANGENT.

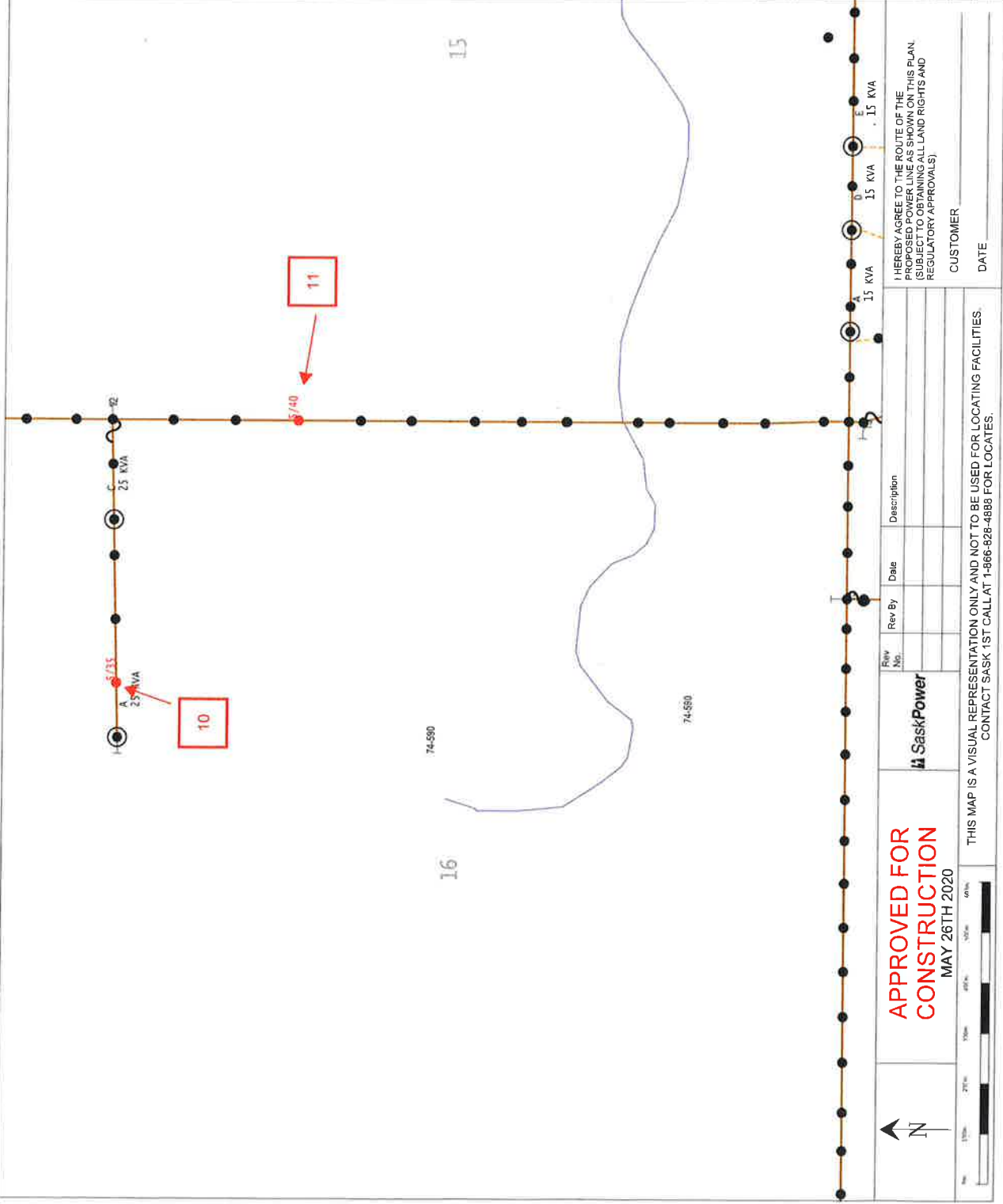

APPROVED FOR CONSTRUCTION
MAY 26TH 2020



THIS MAP IS A VISUAL REPRESENTATION ONLY AND NOT TO BE USED FOR LOCATING FACILITIES.
CONTACT SASK 1ST CALL AT 1-866-828-4888 FOR LOCATES.

I HEREBY AGREE TO THE ROUTE OF THE PROPOSED POWER LINE AS SHOWN ON THIS PLAN. (SUBJECT TO OBTAINING ALL LAND RIGHTS AND REGULATORY APPROVALS)

CUSTOMER _____

DATE _____

DRAWING TITLE

WPMP 2021 RPL-Lumsden 1D64

NOTIFICATION NUMBER

11596691

SERVICE ORDER NUMBER

20278269

LEGAL LAND DESCRIPTION OR CIVIC ADDRESS

NW 15-21-23 W2

LONG/LAT OF AREA

-105.12342, 50.785628

CUSTOMER CONTACT

SASKPOWER

EO PROJECT NUMBER

RE11LU0100011869

FEEDER NAME

LUM-562

DESIGNER NAME

JRISBAULT

DISTRICT

LUMSDEN

SITE CHECKED BY AND DATE

RM NAME AND NUMBER

DUFFERIN 190

PLOT DATE

2023-05-25

PLOT TYPE (L, P, R)

SHEET NO 5 of 7

REV

NOTES:

- ALL STRUCTURES CAN BE FOUND IN THE SASKPOWER CONSTRUCTION STANDARDS MANUAL(CSM)
 - CALL FOR LOCATES PRIOR TO CONSTRUCTION
 - UNLESS SPECIFIED, ALL AREAS TO BE BACKFILLED WITH NATIVE MATERIAL
12. SALVAGE EXISTING POLE TAG #2098585. INSTALL NEW 5/40' POLE AND A1201 TANGENT.

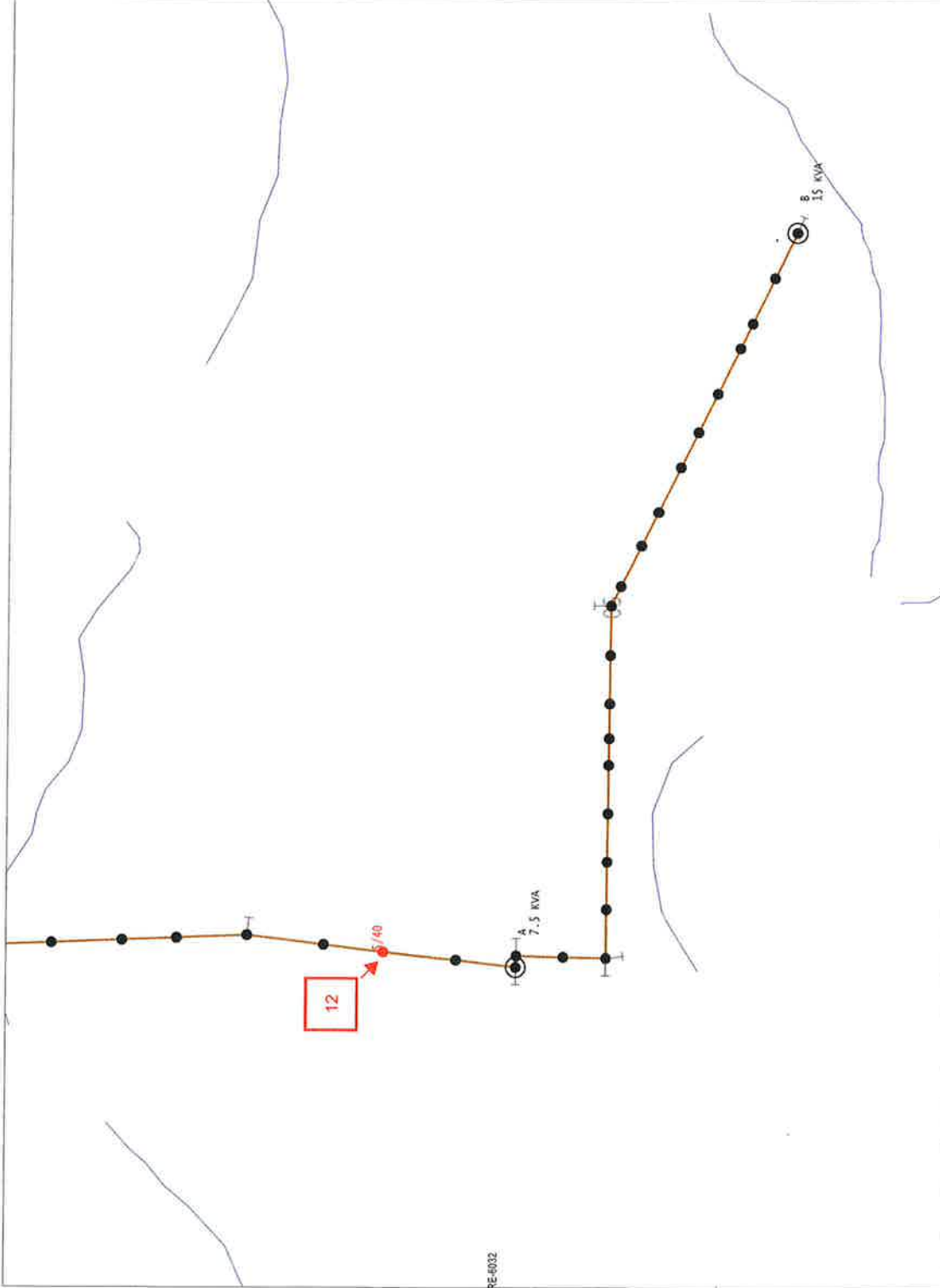

RE-0032

DRAWING TITLE
WPMP 2021 RPL-Lumsden 1D64

NOTIFICATION NUMBER
11596691

SERVICE ORDER NUMBER
20278269

LEGAL LAND DESCRIPTION OR CIVIC ADDRESS
NW 05-21-23 W2

LONGLAT OF AREA
-105.16810, 50.757514

CUSTOMER CONTACT
SASKPOWER

60 PROJECT NUMBER
RE11LU0100011869

FREEDER NAME
LUM-562

DESIGNER NAME
jaisenbuit

SITE CHECKED BY AND DATE
DUFFERIN 190

RM NAME AND NUMBER
DUFFERIN 190

PLOT DATE
2020-05-25

PLOT TYPE
R PM

SHEET NO
6

REV
7

I HEREBY AGREE TO THE ROUTE OF THE PROPOSED LINE AS SHOWN ON THIS PLAN. (SUBJECT TO OBTAINING ALL LAND RIGHTS AND REGULATORY APPROVALS).

CUSTOMER _____

DATE _____

APPROVED FOR CONSTRUCTION
MAY 26TH 2020

MAY 26TH 2020

THIS MAP IS A VISUAL REPRESENTATION ONLY AND NOT TO BE USED FOR LOCATING FACILITIES. CONTACT SASK 1ST CALL AT +866-828-4888 FOR LOCATES.



Rev No.	Rev By	Date	Description



NOTES:

-ALL STRUCTURES CAN BE FOUND IN THE SASKPOWER CONSTRUCTION STANDARDS MANUAL(CSM)
 -CALL FOR LOCATES PRIOR TO CONSTRUCTION
 -UNLESS SPECIFIED, ALL AREAS TO BE BACKFILLED WITH NATIVE MATERIAL

13. SALVAGE EXISTING POLE TAGS #2107210, AND 2107212. INSTALL NEW 5/35' POLES AND A1201 TANGENTS.

14. SALVAGE EXISTING POLE TAGS #2107213, 2107223, 2107225 AND 2107229. INSTALL NEW 5/40' POLES AND A1201 TANGENTS.

15. SALVAGE EXISTING POLE TAG #2107210. INSTALL NEW 4/40' POLE, A1201 TANGENT, A1208 TAPOFF, A2601 CUT OUT, A3203 GUY AND A3215 ANCHOR.

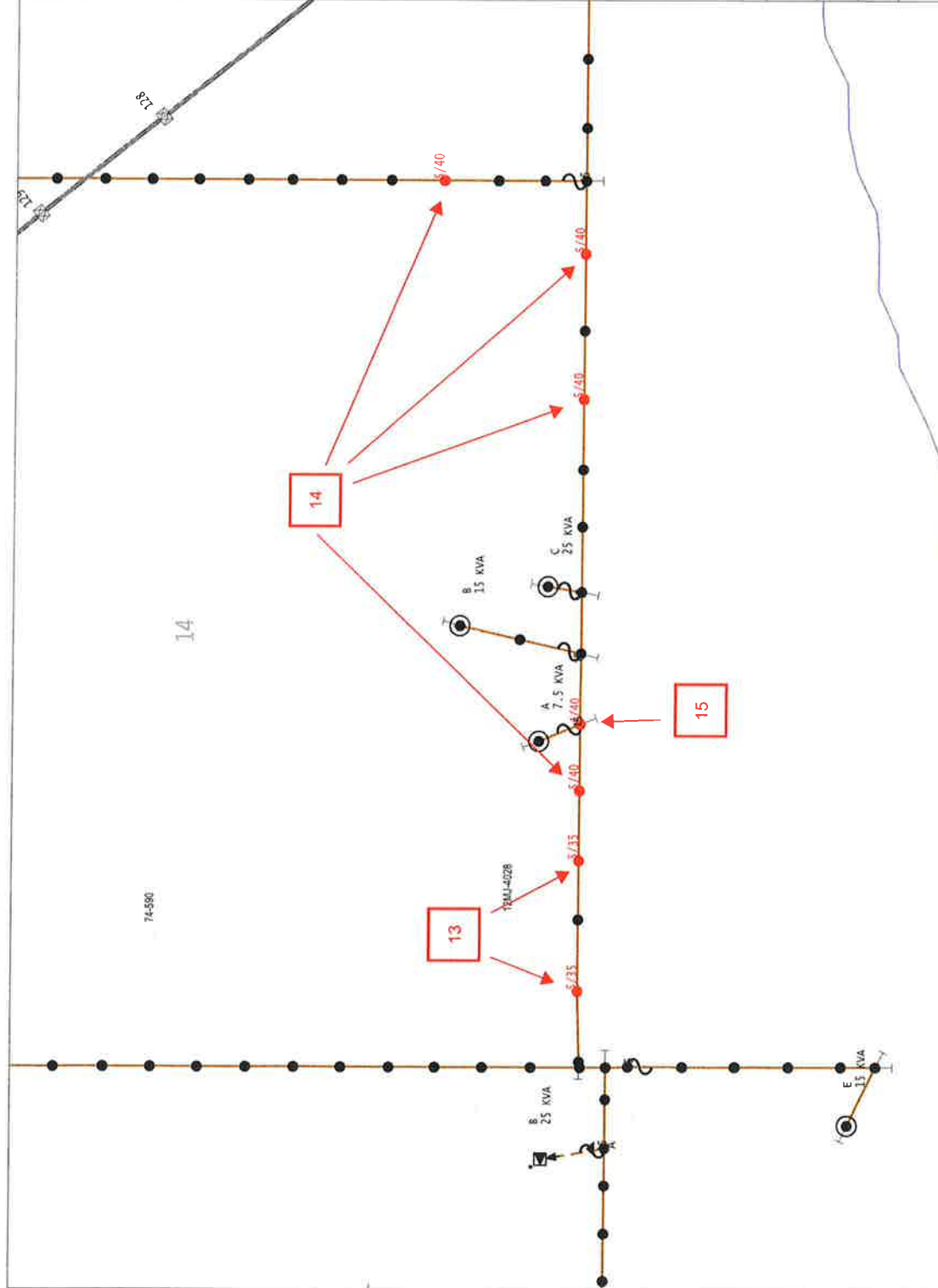

DRAWING TITLE	
WPMP 2021 RPL-Lumsden 1D64	
NOTIFICATION NUMBER	SERVICE ORDER NUMBER
11596691	20278269
LEGAL LAND DESCRIPTION OR CIVIC ADDRESS	LONGLAT OF AREA
SE 14-21-23 W2	-105.08372, 50.776124
CUSTOMER CONTACT	
SASKPOWER	
EO PROJECT NUMBER	RE11LU0100011869
FEEBEE NAME	LUM-562
DESIGNER NAME	JATS/ENRUIT
CIRCUIT NAME	1D-64
DISTRICT	LUMSDEN
SITE CHECKED BY AND DATE	
RM NAME AND NUMBER	DUFFERIN 190
PLOT DATE	2022-05-23
PLOT TYPE	B POE
SHEET NO	7 of 7
REV	

I HEREBY AGREE TO THE ROUTE OF THE PROJECT AS SHOWN ON THIS PLAN (SUBJECT TO OBTAINING ALL LAND RIGHTS AND REGULATORY APPROVALS)

CUSTOMER _____

DATE _____

Rev No.	Rev By	Date	Description

APPROVED FOR CONSTRUCTION

MAY 26TH 2020

THIS MAP IS A VISUAL REPRESENTATION ONLY AND NOT TO BE USED FOR LOCATING FACILITIES. CONTACT SASK 1ST CALL AT 1-866-828-4888 FOR LOCATES